



54, Norley Drive, St. Helens, WA10 5NJ

Asking Price £195,000

*David
Davies* Collection



54, Norley Drive, St. Helens, WA10 5NJ

- Freehold
- Council Tax Band: B
- EPC: C
- Three Bedroom Terraced Home
- Immaculately Presented Throughout
- Stunning New Modern Fitted Kitchen
- Two Reception Rooms
- Ground Floor WC
- Front & Rear Garden
- Excellent Location

David Davies Sales & Lettings are delighted to present to the market this beautifully presented three-bedroom mid-terraced home, occupying a highly sought-after and rarely available position on Norley Drive, Eccleston.

The property offers well-appointed accommodation throughout and briefly comprises a welcoming entrance hallway and ground floor cloakroom/WC, which is currently undergoing renovation to include stylish wall panelling and a newly fitted wash basin, further enhancing the finish of the home.

To the front of the property is a stunning newly fitted modern kitchen, recently upgraded to a high standard and offering an extensive range of wall and base units, quality work surfaces, and ample space for dining. To the rear is a spacious and beautifully presented lounge, which flows seamlessly into a generous conservatory overlooking the rear garden, creating an excellent additional living space.

To the first floor, the landing provides access to three well-proportioned bedrooms, with the principal bedroom benefitting from fitted wardrobes. The accommodation is completed by a stylish fully tiled family bathroom, featuring a walk-in shower, WC, and vanity wash basin.

Further benefits include gas central heating and double glazing throughout.

Externally, to the front there is a private garden area with on-street parking available nearby. To the rear, the property enjoys a beautifully maintained garden, mainly laid to lawn with designated seating areas, creating a perfect setting for relaxing and entertaining during the warmer months.

The property is conveniently located close to a range of local amenities, including shops, bus routes, and excellent commuter links to Liverpool, Manchester, and surrounding areas.

Finished to an excellent standard throughout, this impressive home must be viewed internally to be fully appreciated.

EPC: C





GROUND FLOOR



1ST FLOOR

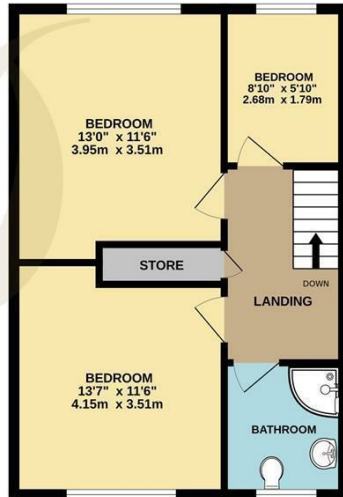

Whilst every attempt has been made to ensure the accuracy of the floorplan contained here, measurements of doors, windows, rooms and any other items are approximate and no responsibility is taken for any error, omission or mis-statement. This plan is for illustrative purposes only and should be used as such by any prospective purchaser. The services, systems and appliances shown have not been tested and no guarantee as to their operability or efficiency can be given.
Made with Metrage CS222



Our family owned Independent Estate Agency was established in 1981 and provides a *refreshingly professional service* combining traditional values with a modern approach.

David Paul David

